



**GLOBAL POLYMER INDUSTRIES**

P.O.Box 1428; 2 Volt Street, Industrial West; OTJIWARONGO / NAMIBIA



e-mail: info@styrotex.com.na ; Tel : 067 - 303191/2

TDS 041/February 2020

## Structurally Insulated Panel Technology

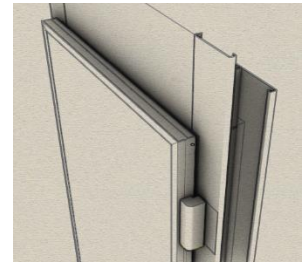
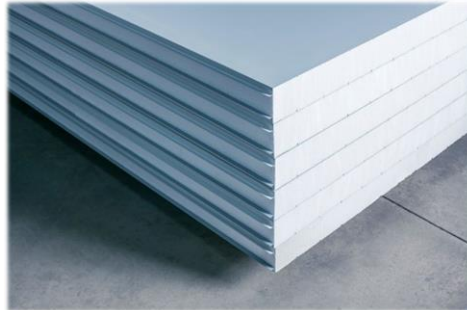
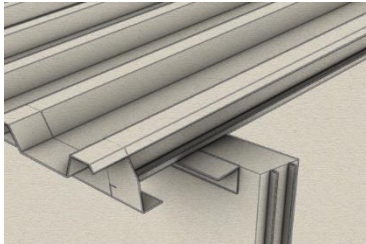

### PANELS

Sheeting (metal, timber, cement) laminated onto Styrotex Expanded PolyStyrene fire retardant core;

### DURABILITY

long-term and weather proof if proper maintained;

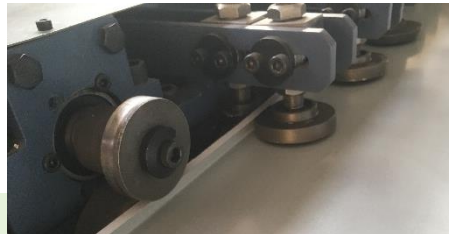

State of the Art production facilities to guarantee production quality and capacity



**FACTORY WAREHOUSE**



**OFFICE BUILDING**



**SiPANEL HOME**



**CONTAINER CONVERSIONS**



**COLD STORAGE FACILITIES**



The information contained herein is provided for general purposes only and may be changed for the purpose of improving the system. By providing the information contained herein Global Polymer Industries cc makes no guaranty or warranty, and does not assume any liability with respect to the accuracy or completeness of such information, or the product results in any specific instance and hereby expressly disclaims any implied warranties of merchantability or fitness for a particular purpose, or any other warranties or representations whatsoever, expressed or implied.

